

Name of school	Photo reference
TRUNCH	Trunch 001-005 jpg.
Grid Reference TG 28613492 Is the building listed? No	
School Address One wall of the school remains on corner of churchyard	

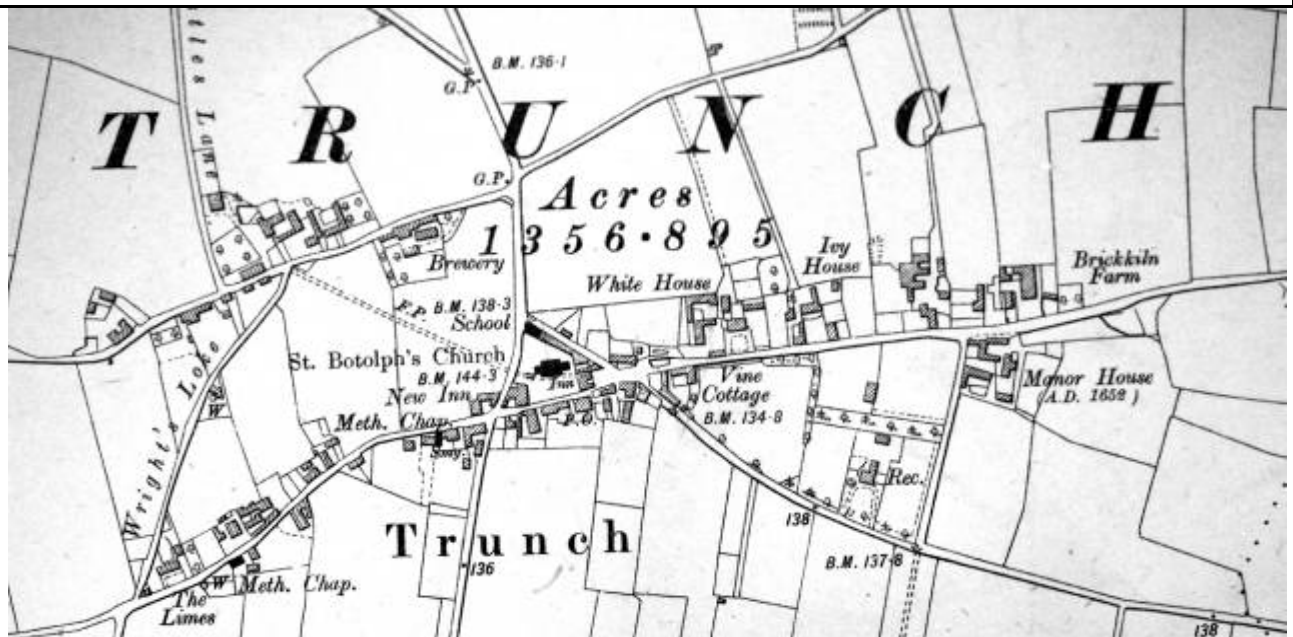

Photograph	Photograph
<p>Remaining wall of school</p>	

Document references

Building plans in NRO	P/BG/120 Architect's plans
Building plans in other	X
Sale particulars in NRO	X
Sale particulars in other	x
Log books in NRO	C/ED 2/31 April 1877 - Jan 1905 C/ED 2/32 Feb 1905 - April 1933
Log books in school	X
Photographs in NRO Other docs in NRO	X Acc 2009/304 (1903 survey) p.421
Photographs in other Other doc.sources	X National Society Archive NS/7/1/12864

Directory entry (1920s or nearest date)	White 1883 p.751 A neat school was built in 1852 Kelly 1904 - Public Elementary School (mixed) erected in 1853 for 72 children. Average attendance 55. Miss Lloyd mistress. Kelly 192 p.526 - Public Elementary School (infants) erected 1853 for 72 children. Miss Page Mistress. The elder children attend the schools at Mundesley and Knapton NCC Ed.Com Development Plan no mention
Date of construction	1853 according to White
Architects (if known)	x
Position within parish	Central., on a corner abutting on the churchyard.
Catchment area in 1940s	Trunch

Plan – describe or include scan

Only the north, side wall of this school survives, standing to eaves level, with blocked windows. It now forms the boundary wall for the ex-school house garden.

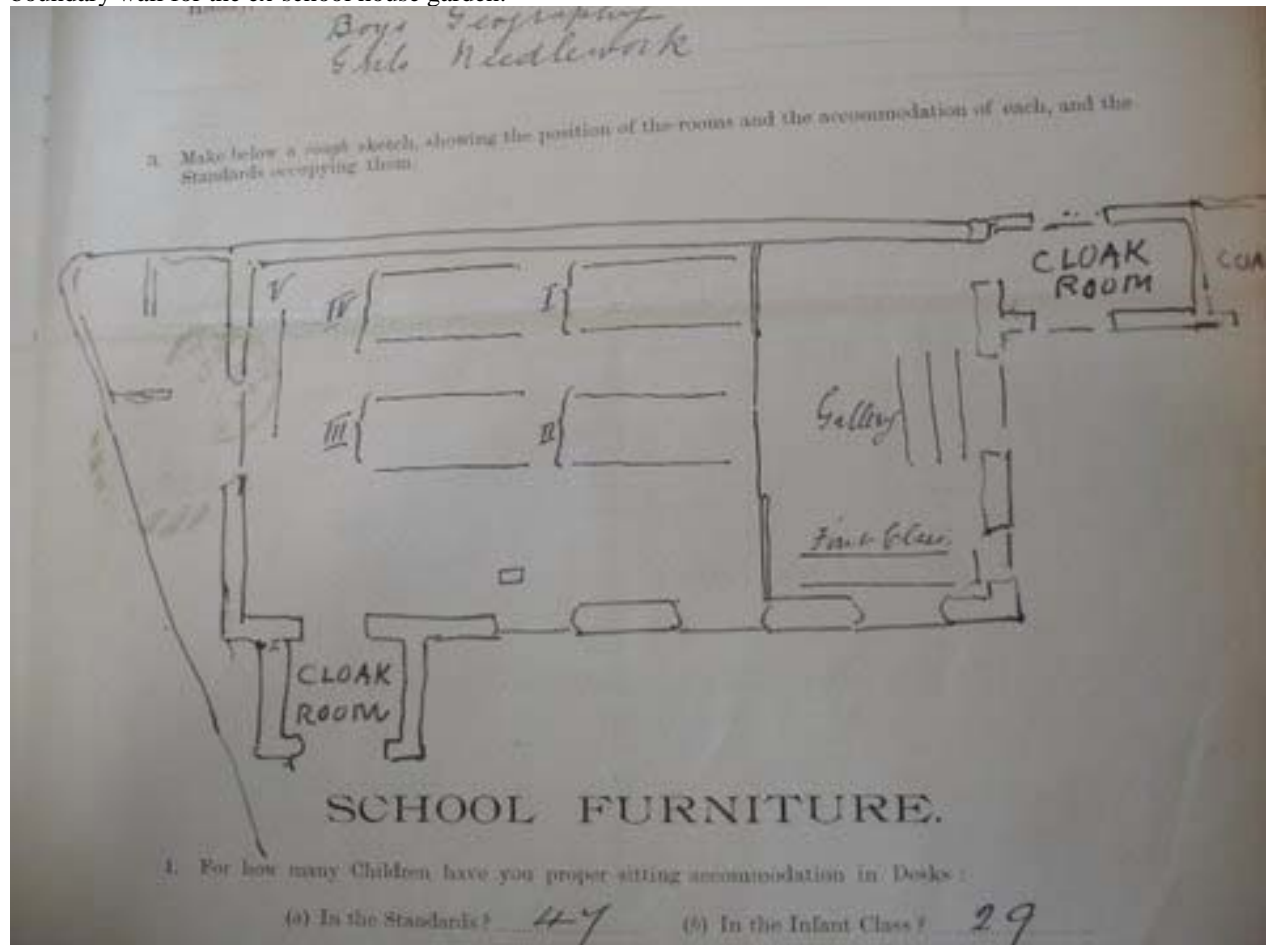

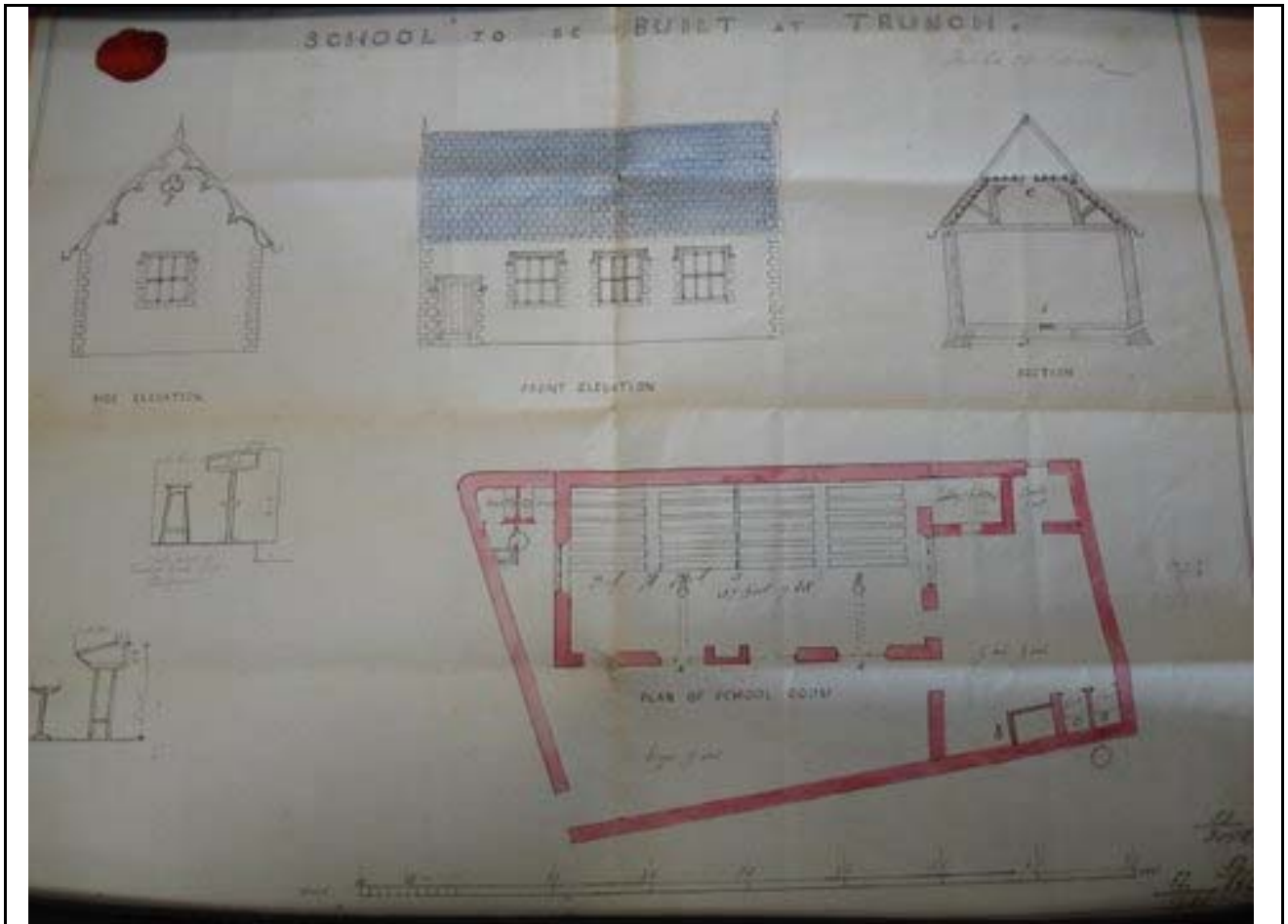

NRO P/BG 120

How many storeys	Single
How many rooms	one
Present use	Garden wall
Name of present owner	x
Condition (1 =derelict – 5 = good)	0
Is there a teacher's house associated with school? Give some idea of date, size and style	.Cottage, appears to be earlier than the school. The cottage faces the school site, now its garden.

Building Features

<i>Windows: number, position, size, no of lights, style (sash, leaded, etc)</i>	3 blocked windows
<i>Chimneys: number, style</i>	x
<i>Ventilators: number, position</i>	x
<i>Doors: number, position, inscription over (Boys – Girls) style</i>	Dorr remains with pointed arch and vertical panelled door.
<i>Porches: number, position, inscription etc</i>	x
<i>Bell towers/clock and other ornamentation</i>	x

Overall style

<i>Gothic/ecclesiastical (pointed windows and doors)</i>	x
<i>Classical/Georgian (triangular pediments, sash windows)</i>	x
<i>Tudor/flat headed windows with drip moulding, ornate chimneys</i>	x
<i>Plain and functional with no ornamentation</i>	x
<i>Inscriptions, coats of arms etc</i>	x

Building materials

Roof-note decorative features (coloured and fancy tiles)	x
Walls-note decorative work (flint work, diaper bricks etc)	Remaining wall is flint pebbles, set endways into the mortar. White brick rusticated quoins to main part and red brick quoins at west end of wall and red brick dressings around the windows.

For architectural terminology, see the glossary in Pevsner

Internal (room by room) materials and features such as:

<i>Panelled walls</i>	x
-----------------------	---

<i>Fire places/heating appliances</i>	x
<i>Plaster/modern ceilings, open to roof</i>	x
<i>Original cupboards</i>	x
<i>Room divisions/folding doors</i>	x
<i>Permanent art work</i>	x

Building sequence

Only one wall remains standing. The architect's plans show this wall so the building on the plan appears to have been built. A circular window with trefoil detail (as shown on the plan) survives as a garden feature.

Playground

<i>Size (approx)</i>	X
<i>Type (tarmac enclosure, field – nature garden, climbing frames, games painted on ground Boundary –original brick, iron fencing etc.</i>	X
<i>Buildings – out houses, mobiles, 'offices'</i>	x

Include here any additional material (scans of sketch plans, old photographs, oral evidence, etc, précis of school history

A school at Trunch was held in the chancel of the parish church 1646 - 1750 (see *Trunch Miscellany. A Walk around Guide.*)

The choir stalls have much graffiti, some 18C dates, and holes for ink wells.

Date of survey	4.11.11
Name(s) of surveyor(s)	Mary Ash and Janet Ede

